

# bluePRO Series [GRINDER]

**GR bluePRO** models incorporate a grinding system comprising a revolving three-bladed knife rigidly mounted on the drive shaft and a steel plate with holes with sharp edges.

This system, capable of speeds of up to 69,000 cuts per minute, finely chops filaments and expels them along the discharge pipeline with no risk of impeller jamming, also keeping the pipeline clean.

Cast iron construction guarantees low vibration and excellent reliability.

In single-phase version, the pump comes in an outer

case containing a circuit breaker to ensure a high startup torque and effective cutting even during restarts.

It also contains an overload protection device which not only provides integral thermal protection for the stator but also offers additional safeguards for the motor when handling heavily soiled liquids.

## Applications

Used for the lifting and transfer of heavily soiled wastewaters, sewage and civil and industrial wastewaters, even on narrow pipelines.

Suitable for pumping liquids containing even long filaments and fibres and large-sized destructible solid bodies.

Suitable for applications requiring high pressure levels.



### CHOPPER KNIFE [GR bluePRO]

Rugged three-bladed chromium steel chopper knife specially treated for added hardness and reliability when cutting solid bodies.

### ANTI-CLOGGING SYSTEM [GR bluePRO]

The special design of the hydraulic part aids the expulsion of suspended solids and prevents fouling of the impeller.



# bluePRO Series



## HANDLE

Ergonomic handle styled for optimal grip. Shaped to take a shackle to hold the pump steady during handling.

## ADJUSTABLE FLOAT SWITCH

Float switch stroke adjustment system for modification of start-stop levels.



## CABLE GLAND

Innovative cable gland system with cable holder system and twin O-rings to ensure maximum tightness. Simpler extraction for maintenance.

## CAPACITOR

Single-phase models have internal capacitor.



## CASE

EN-GJL-250 cast iron construction guarantees solidity and durability even in case of maintenance requiring removal and replacement of the motor.



## STRAINER [DR bluePRO]

Stainless steel suction strainer and diffuser plate (models 50, 75 and 100). Techno-polymer suction strainer with cast iron diffuser plate and foot (models 150 and 200).

## Highlight



## BREATHER [DG bluePRO] [DR bluePRO]

Breather for venting the air accumulated inside the pump after the pit empties, ensuring reliable pump priming even after long periods out of use.

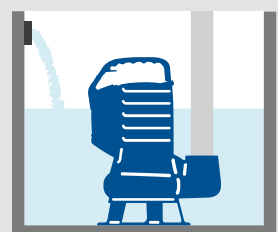
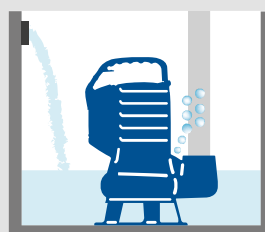
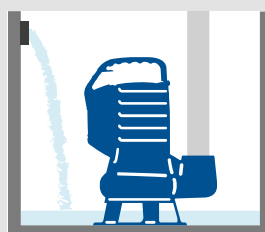

# bluePRO Series



## PRESSURISED TESTING

Stud bolt for closing the motor compartment for the pressurised testing every model undergoes.

## DATAPLATE

Laser-engraved stainless steel dataplate, perfectly legible even after long periods underwater. Slotted in place for easy removal.



## MECHANICAL SEALS

Two silicon carbide (2SiC) mechanical seals in oil chamber.



## V-RING

The V-Ring in direct contact with the liquid protects the mechanical seals from foreign bodies to keep them in good working condition.

## OIL CHAMBER

Guarantees longer mechanical seal lifetime and is easily accessible to simplify maintenance procedures.

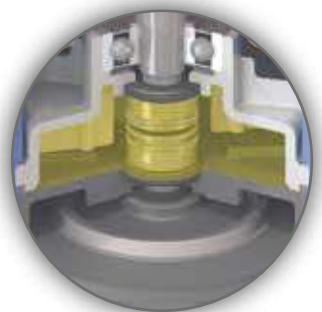

## FREE PASSAGE [DG bluePRO]

Full free passage allowing the expulsion of solids up to 50 mm and preventing fouling of the impeller.

## ANTI-CLOGGING SYSTEM [DR bluePRO]

Stainless steel diffuser plate. Ensures the expulsion of small suspended solids and prevents fouling of the impeller.



# DG *bluePRO*

Models with vertical threaded discharge [GAS 1½"] - 2 poles

## Performances

	l/s	0	1	2	3	4	5	6	7
	l/min	0	60	120	180	240	300	360	420
	m³/h	0	3.6	7.2	10.8	14.4	18.0	21.6	25.2
①	DG bluePRO 50/2/G40V A1BM[T]5		6.0	4.9	3.6	2.4	1.1		
②	DG bluePRO 75/2/G40V A1BM[T]5		9.1	8.0	6.8	5.5	4.1	2.6	
③	DG bluePRO 100/2/G40V A1BM[T]5		10.7	9.8	8.7	7.4	5.9	4.4	2.7

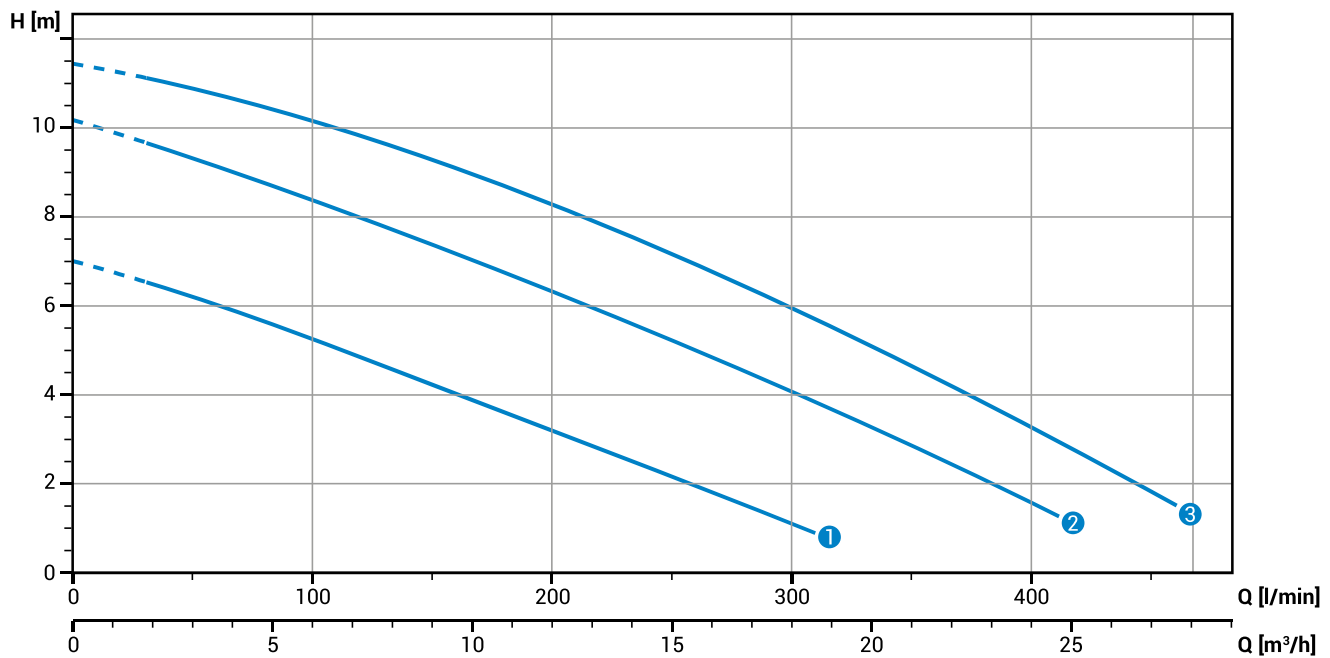

## Technical data

	V	Phases	P1 [kW]	P2 [kW]	A	Rpm	Ø	Free passage	
①	DG bluePRO 50/2/G40V A1BM5	230	1	-	0.37	2.8	2900	G 1½"	40 mm
②	DG bluePRO 75/2/G40V A1BM5	230	1	-	0.55	4.1	2900	G 1½"	40 mm
③	DG bluePRO 100/2/G40V A1BM5	230	1	-	0.74	5.6	2900	G 1½"	40 mm
①	DG bluePRO 50/2/G40V A1BT5	400	3	-	0.37	1.15	2900	G 1½"	40 mm
②	DG bluePRO 75/2/G40V A1BT5	400	3	-	0.55	1.6	2900	G 1½"	40 mm
③	DG bluePRO 100/2/G40V A1BT5	400	3	-	0.74	2.15	2900	G 1½"	40 mm

# DG *bluePRO*

Models with vertical threaded discharge [GAS 2"] - 2 poles

## Performances

	l/s	0	2	4	6	8	10	12
	l/min	0	120	240	360	480	600	720
	m <sup>3</sup> /h	0	7.2	14.4	21.6	28.8	36.0	43.2
①	DG bluePRO 150/2/G50V A1CM[T]5		10.7	8.8	6.5	4.4	2.4	
②	DG bluePRO 200/2/G50V A1CM[T]5		13.7	11.7	9.4	7.1	4.7	2.5

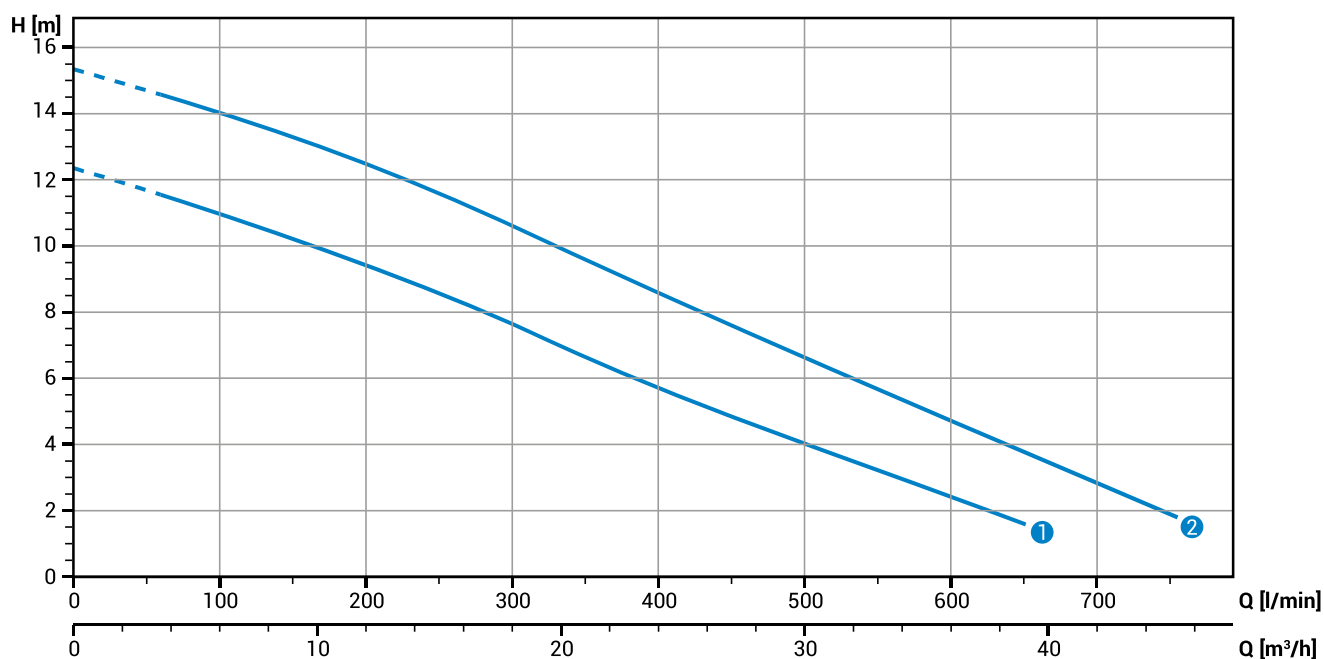

## Technical data

	V	Phases	P1 [kW]	P2 [kW]	A	Rpm	Ø	Free passage	
①	DG bluePRO 150/2/G50V A1CM5	230	1	-	1.1	7.5	2900	G 2"	50 mm
②	DG bluePRO 200/2/G50V A1CM5	230	1	-	1.5	10.0	2900	G 2"	50 mm
①	DG bluePRO 150/2/G50V A1CT5	400	3	-	1.1	3.2	2900	G 2"	50 mm
②	DG bluePRO 200/2/G50V A1CT5	400	3	-	1.5	4.3	2900	G 2"	50 mm



# DG bluePRO

## Dimensions

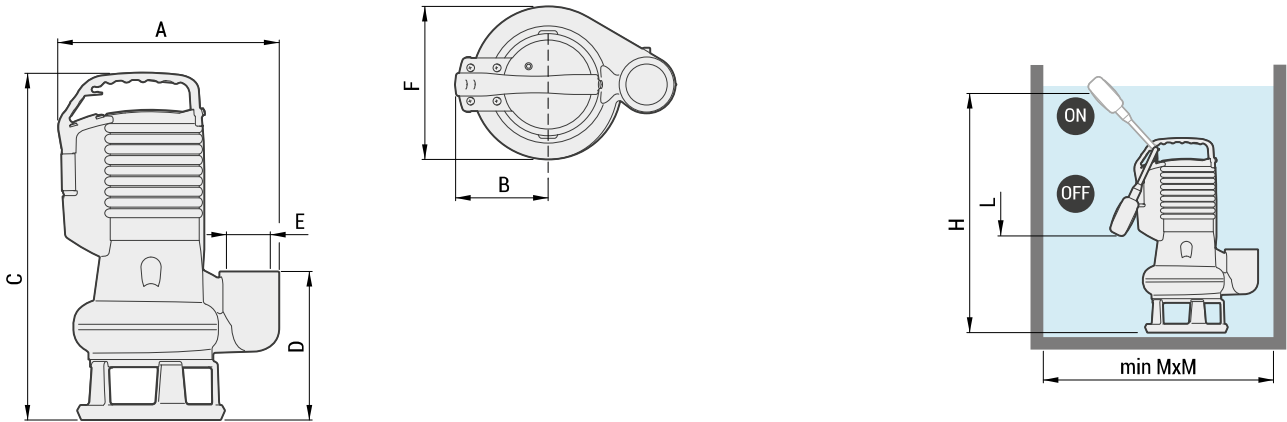

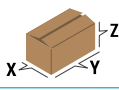
	Overall dimensions (mm)													Pieces per pallet 1000x1200 mm
	A	B	C	D	E	F	H	L	M	kg	X	Y	Z	
DG bluePRO 50/2/G40V A1BM[T]5	265	115	335	140	GAS 1½"	190	420	210	300	13	200	240	400	75 (25x3) 50 (25x2)
DG bluePRO 75/2/G40V A1BM[T]5	265	115	365	140	GAS 1½"	190	450	240	300	15	200	240	400	75 (25x3) 50 (25x2)
DG bluePRO 100/2/G40V A1BM[T]5	265	115	365	140	GAS 1½"	190	450	240	300	15.5	200	240	400	75 (25x3) 50 (25x2)
DG bluePRO 150/2/G50V A1CM[T]5	295	125	465	195	GAS 2"	200	525	335	400	23	250	300	480	32 (16x2)
DG bluePRO 200/2/G50V A1CM[T]5	295	125	465	195	GAS 2"	200	525	335	400	24	250	300	480	32 (16x2)

M - Minimum dimensions. Suggested dimensions 500mm x 500mm

## Versions

### Single-phase models

- TC Thermal protection, capacitor
- TCG Thermal protection, capacitor, float switch

### Three-phase models

- NAE No electric accessory
- TRG Thermal protection, relay for motor protection, float switch

## Packaging



The rugged cardboard box packaging fulfils two functions: it protects the product in transit, thanks to the thickness of the board used and expanded polyurethane padding, and also provides key information about the pump's use and performance data, printed clearly and legibly in colour. Pumps are supplied complete with all the documentation required by European standards and a copy of the duty dataplate on a silvered decal that can be affixed to the manual to ensure the availability of all the most useful data (serial number, power rating, etc.) at all times.

## Installations

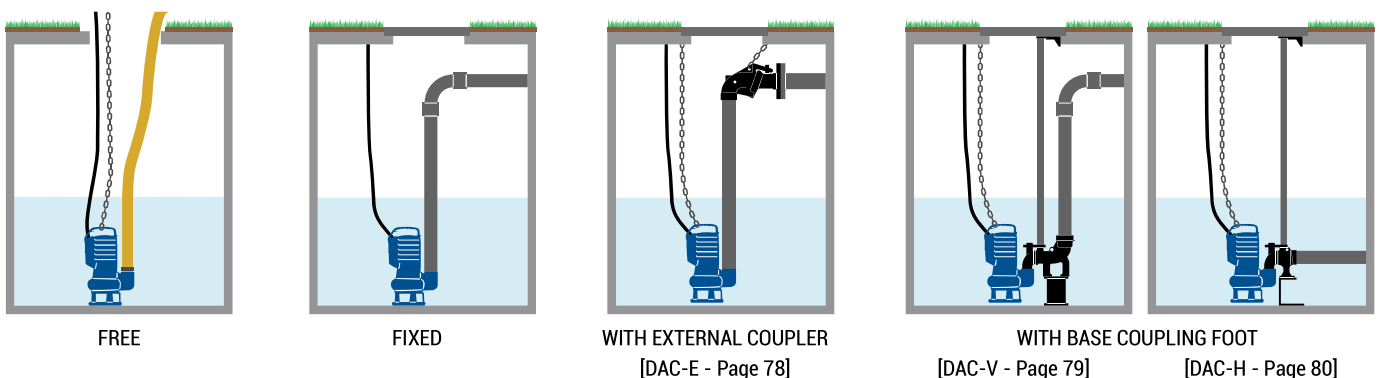

# DR *bluePRO*

Models with vertical threaded discharge [GAS 1 ¼"] - 2 poles

## Performances

	l/s	0	1	2	3	4	5
	l/min	0	60	120	180	240	300
	m³/h	0	3.6	7.2	10.8	14.4	18.0
① DR bluePRO 50/2/G32V A1BM[T]5			7.9	6.8	5.3	3.4	
② DR bluePRO 75/2/G32V A1BM[T]5			11.3	10.0	8.2	5.3	
③ DR bluePRO 100/2/G32V A1BM[T]5			13.5	12.1	10.1	7.4	3.1

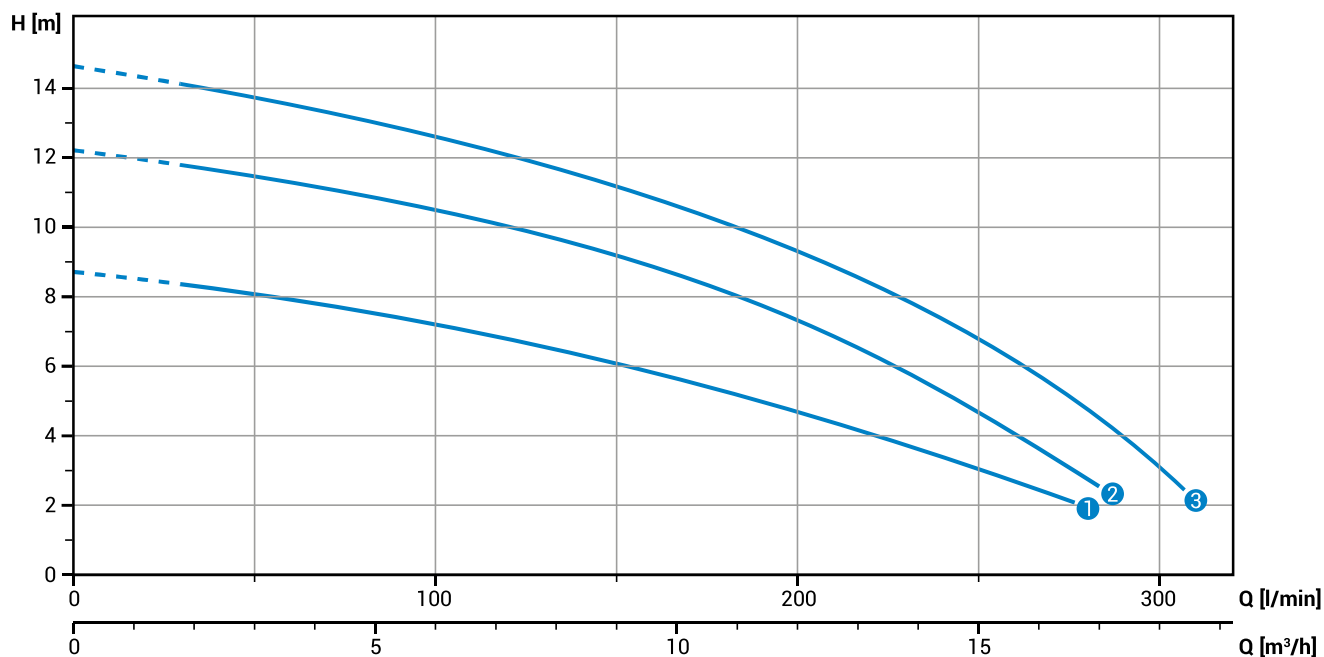

## Technical data

	V	Phases	P1 [kW]	P2 [kW]	A	Rpm	Ø	Free passage
① DR bluePRO 50/2/G32V A1BM5	230	1	-	0.37	2.8	2900	G 1 ¼"	15 mm
② DR bluePRO 75/2/G32V A1BM5	230	1	-	0.55	4.1	2900	G 1 ¼"	15 mm
③ DR bluePRO 100/2/G32V A1BM5	230	1	-	0.74	5.6	2900	G 1 ¼"	15 mm
① DR bluePRO 50/2/G32V A1BT5	400	3	-	0.37	1.15	2900	G 1 ¼"	15 mm
② DR bluePRO 75/2/G32V A1BT5	400	3	-	0.55	1.6	2900	G 1 ¼"	15 mm
③ DR bluePRO 100/2/G32V A1BT5	400	3	-	0.74	2.15	2900	G 1 ¼"	15 mm

# DR *bluePRO*

Models with vertical threaded discharge [GAS 2"] - 2 poles

## Performances

	l/s	0	2	4	6	8	10
	l/min	0	120	240	360	480	600
	m <sup>3</sup> /h	0	7.2	14.4	21.6	28.8	36.0
①	DR bluePRO 150/2/G50V A1CM[T]5		12.6	10.9	8.9	6.5	3.1
②	DR bluePRO 200/2/G50V A1CM[T]5		15.3	13.3	10.9	8.1	5.1

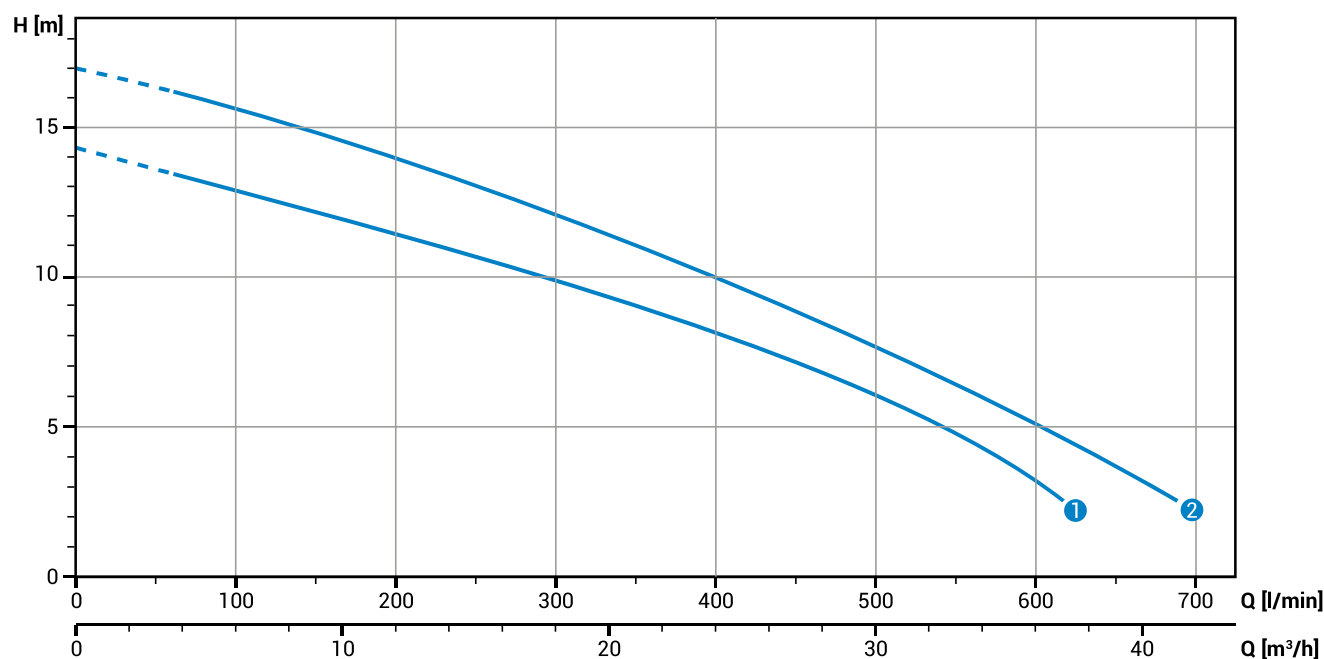

## Technical data

	V	Phases	P1 [kW]	P2 [kW]	A	Rpm	Ø	Free passage	
①	DR bluePRO 150/2/G50V A1CM5	230	1	-	1.1	7.5	2900	G 2"	10x30 mm
②	DR bluePRO 200/2/G50V A1CM5	230	1	-	1.5	10	2900	G 2"	10x30 mm
①	DR bluePRO 150/2/G50V A1CT5	400	3	-	1.1	3.2	2900	G 2"	10x30 mm
②	DR bluePRO 200/2/G50V A1CT5	400	3	-	1.5	4.3	2900	G 2"	10x30 mm



# DR bluePRO

## Dimensions

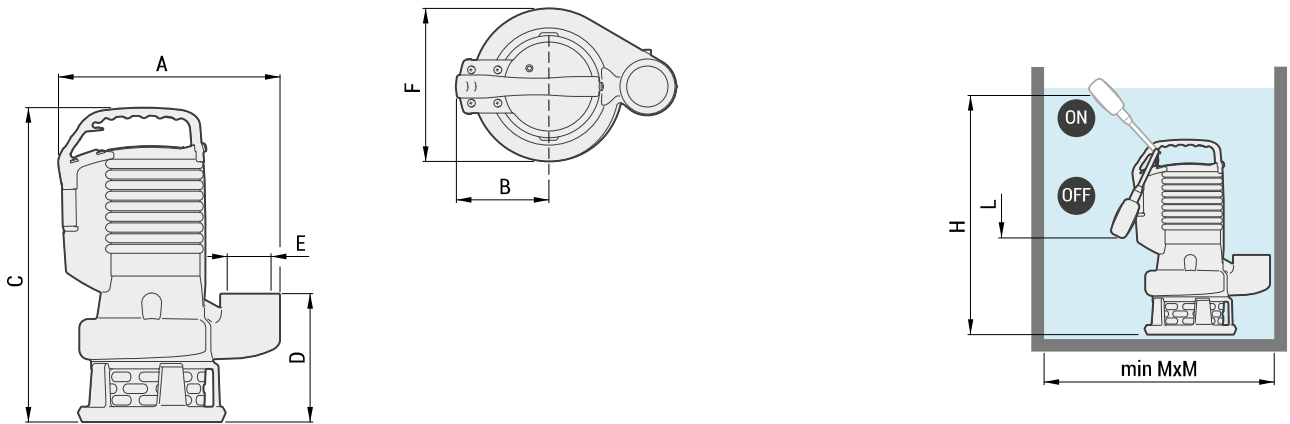

Overall dimensions (mm)

	Overall dimensions (mm)										kg				Pieces per pallet	
	A	B	C	D	E	F	H	L	M	X		Y	Z	1000x1200 mm		
DR bluePRO 50/2/G32V A1BM[T]5	255	115	290	110	GAS 1 1/4"	150	380	170	300	12	200	240	350	75 (25x3)	50 (25x2)	
DR bluePRO 75/2/G32V A1BM[T]5	255	115	320	110	GAS 1 1/4"	150	410	200	300	13.5	200	240	350	75 (25x3)	50 (25x2)	
DR bluePRO 100/2/G32V A1BM[T]5	255	115	320	110	GAS 1 1/4"	150	410	200	300	14	200	240	350	75 (25x3)	50 (25x2)	
DR bluePRO 150/2/G50V A1CM[T]5	295	125	420	170	GAS 2"	200	480	290	400	23	250	300	480	32 (16x2)		
DR bluePRO 200/2/G50V A1CM[T]5	295	125	420	170	GAS 2"	200	480	290	400	24	250	300	480	32 (16x2)		

M - Minimum dimensions. Suggested dimensions 500mm x 500mm

## Versions

### Single-phase models

- TC Thermal protection, capacitor
- TCG Thermal protection, capacitor, float switch

### Three-phase models

- NAE No electric accessory
- TRG Thermal protection, relay for motor protection, float switch

## Packaging



The rugged cardboard box packaging fulfils two functions: it protects the product in transit, thanks to the thickness of the board used and expanded polyurethane padding, and also provides key information about the pump's use and performance data, printed clearly and legibly in colour. Pumps are supplied complete with all the documentation required by European standards and a copy of the duty dataplate on a silvered decal that can be affixed to the manual to ensure the availability of all the most useful data (serial number, power rating, etc.) at all times.

## Installations

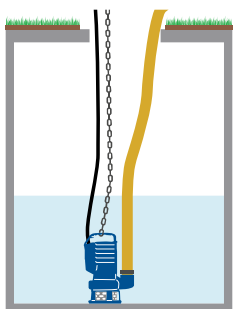

FREE

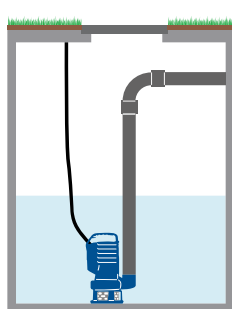

FIXED

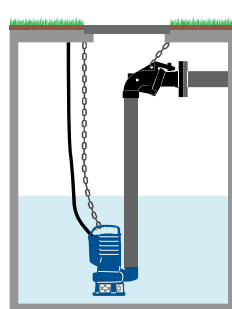

WITH EXTERNAL COUPLER  
[DAC-E - Page 78]

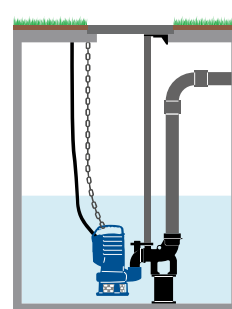

WITH BASE COUPLING FOOT  
[DAC-V - Page 79]

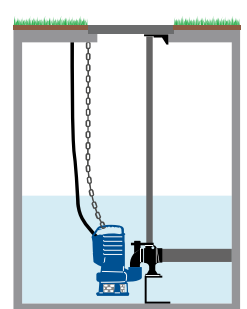

[DAC-H - Page 80]

# GR *bluePRO*

Models with horizontal flanged and threaded discharge [GAS 1½" - DN32 PN6] - 2 poles

## Performances

	l/s	0	1	2	3	4	5
	l/min	0	60	120	180	240	300
	m³/h	0	3.6	7.2	10.8	14.4	18.0
①	GR bluePRO 100/2/G40H A1CM[T]5		16.4	14.4	11.5	6.9	
②	GR bluePRO 150/2/G40H A1CM[T]5		19.6	17.9	15.1	10.4	3.0
③	GR bluePRO 200/2/G40H A1CM[T]5		25.6	23.6	20.7	16.1	9.3

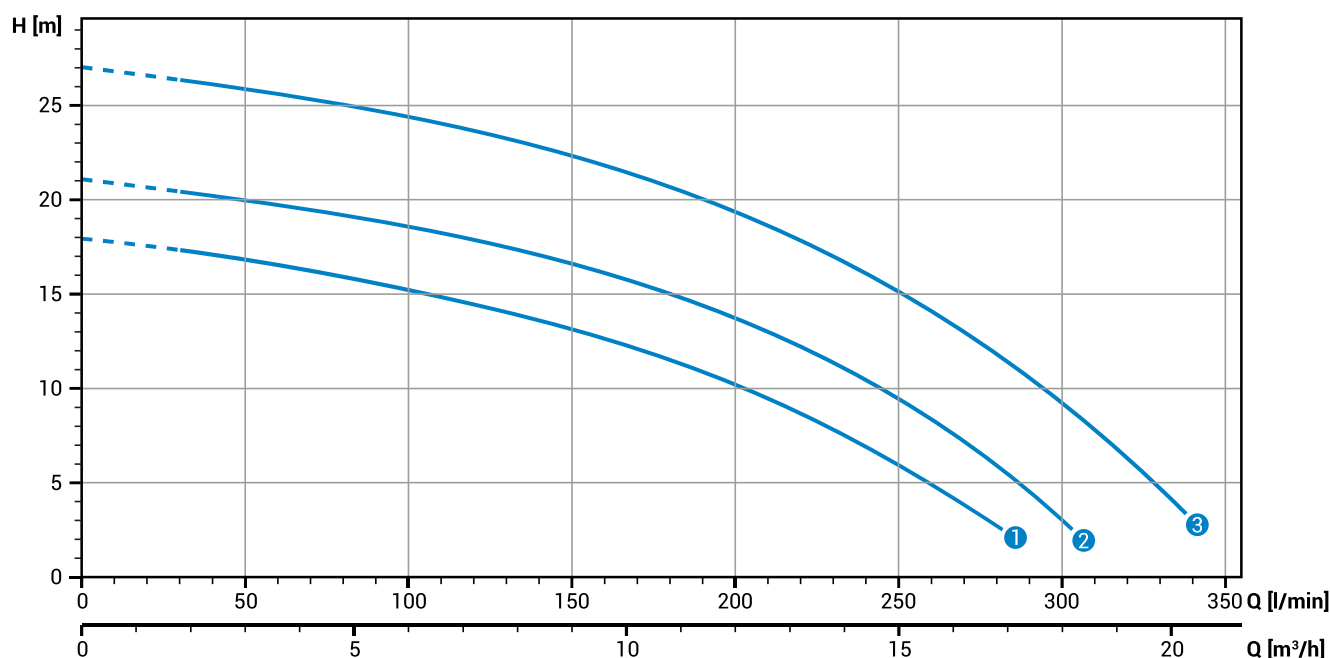

## Technical data

	V	Phases	P1 [kW]	P2 [kW]	A	Rpm	Start	Ø	Free passage	
①	GR bluePRO 100/2/G40H A1CM5	230	1	-	0.74	5.5	2900	Dir	G 1½"- DN32 PN6	-
②	GR bluePRO 150/2/G40H A1CM5	230	1	-	1.10	7.5	2900	Dir	G 1½"- DN32 PN6	-
③	GR bluePRO 200/2/G40H A1CM5	230	1	-	1.50	10	2900	Dir	G 1½"- DN32 PN6	-
①	GR bluePRO 100/2/G40H A1CT5	400	3	-	0.74	2.7	2900	Dir	G 1½"- DN32 PN6	-
②	GR bluePRO 150/2/G40H A1CT5	400	3	-	1.10	3.2	2900	Dir	G 1½"- DN32 PN6	-
③	GR bluePRO 200/2/G40H A1CT5	400	3	-	1.50	4.3	2900	Dir	G 1½"- DN32 PN6	-

# GR bluePRO

## Dimensions

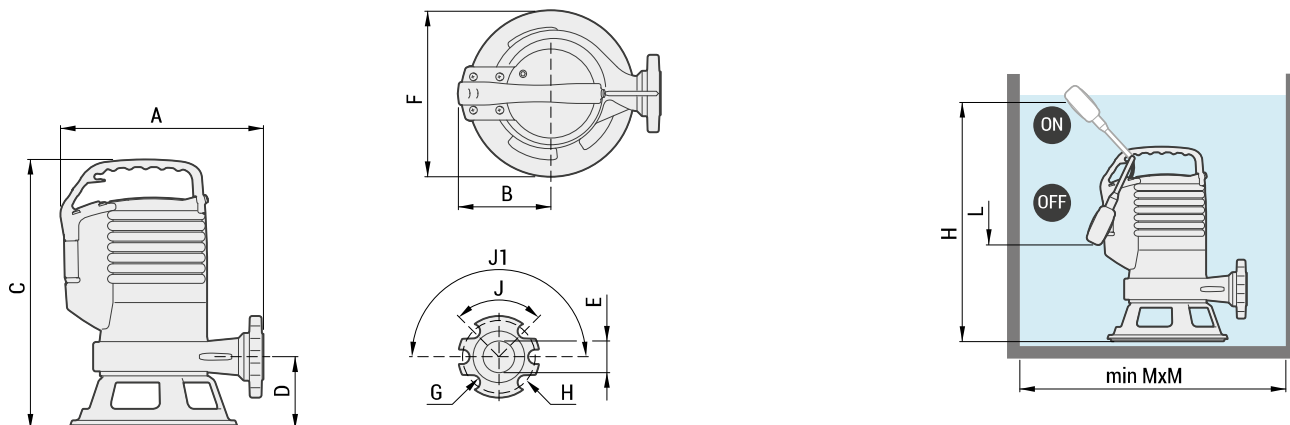

Overall dimensions (mm)

	Overall dimensions (mm)											kg				Pieces per pallet 1000x1200 mm		
	A	B	C	D	E	F	G	H	J	J1	H		L	M	X		Y	Z
GR bluePRO 100/2/G40H A1CM[T]5	270	130	365	95	GAS 1½"	220	14	90	90°	180°	450	240	450	19	250	300	400	48 (16x3) 32 (16x2)
GR bluePRO 150/2/G40H A1CM[T]5	285	125	410	100	GAS 1½"	230	14	90	90°	180°	495	285	450	24	250	300	440	32 (16x2)
GR bluePRO 200/2/G40H A1CM[T]5	285	125	410	100	GAS 1½"	230	14	90	90°	180°	495	285	450	26	250	300	440	32 (16x2)

M - Minimum dimensions. Suggested dimensions 500mm x 500mm

## Versions

### Single-phase models

TCDT Thermal protection, capacitor, startup capacitor, overload protection

TCDGT Thermal protection, capacitor, startup capacitor, overload protection, float switch

### Three-phase models

TR Thermal protection, relay for motor protection

TRG Thermal protection, relay for motor protection, float switch

## Packaging



The rugged cardboard box packaging fulfils two functions: it protects the product in transit, thanks to the thickness of the board used and expanded polyurethane padding, and also provides key information about the pump's use and performance data, printed clearly and legibly in colour. Pumps are supplied complete with all the documentation required by European standards and a copy of the duty dataplate on a silvered decal that can be affixed to the manual to ensure the availability of all the most useful data (serial number, power rating, etc.) at all times.

## Installations

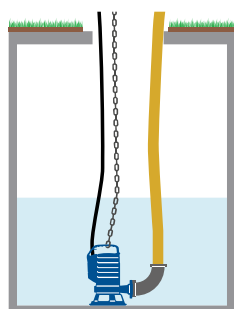

FREE

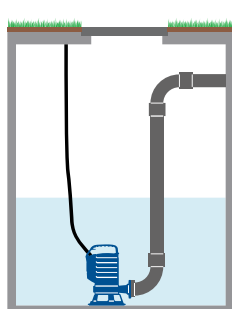

FIXED

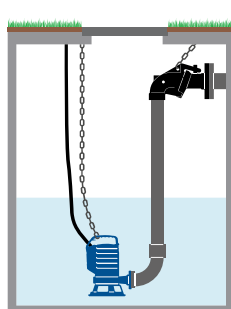

WITH EXTERNAL COUPLER  
[DAC-E - Page 78]

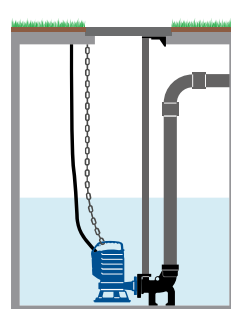

WITH BASE COUPLING FOOT  
[DAC-V - Page 79]

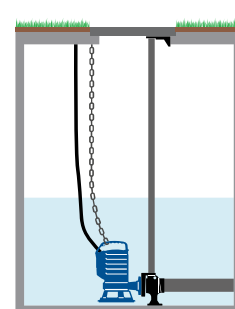

WITH BASE COUPLING FOOT  
[DAC-H - Page 80]

# AP bluePRO

Models with horizontal flanged and threaded discharge [GAS 1½" - DN32 PN6] - 2 poles

## Performances

	l/s	0	1	2	3	4	5	6	7
	l/min	0	60	120	180	240	300	360	420
	m³/h	0	3.6	7.2	10.8	14.4	18.0	21.6	25.2
①	AP bluePRO 100/2/G40H A1CM[T]5		16.3	14.9	13.1	10.9	7.8	3.6	
②	AP bluePRO 150/2/G40H A1CM[T]5		19.8	18.5	16.7	14.6	11.7	7.8	
③	AP bluePRO 200/2/G40H A1CM[T]5		25.4	23.8	21.9	19.6	16.7	12.7	6.6

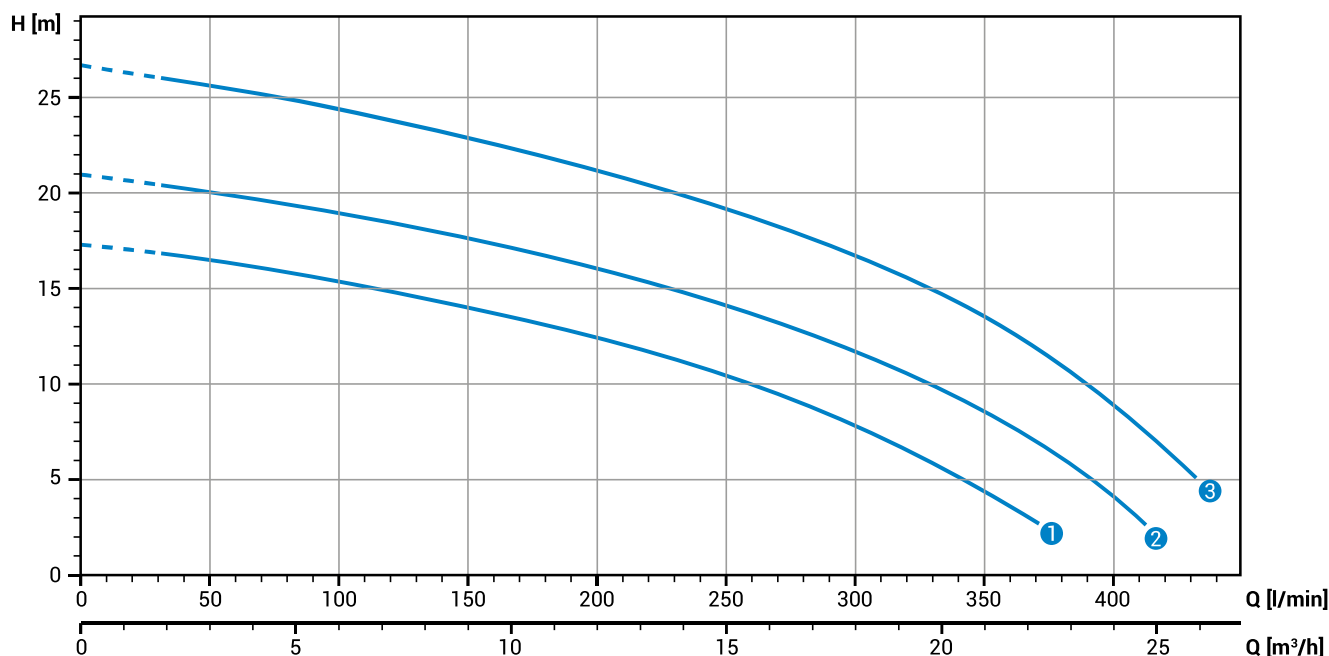

## Technical data

	V	Phases	P1 [kW]	P2 [kW]	A	Rpm	Start	Ø	Free passage	
①	AP bluePRO 100/2/G40H A1CM5	230	1	-	0.74	5.5	2900	Dir	G 1½"- DN32 PN6	6 mm
②	AP bluePRO 150/2/G40H A1CM5	230	1	-	1.10	7.5	2900	Dir	G 1½"- DN32 PN6	6 mm
③	AP bluePRO 200/2/G40H A1CM5	230	1	-	1.50	10.0	2900	Dir	G 1½"- DN32 PN6	6 mm
①	AP bluePRO 100/2/G40H A1CT5	400	3	-	0.74	2.7	2900	Dir	G 1½"- DN32 PN6	6 mm
②	AP bluePRO 150/2/G40H A1CT5	400	3	-	1.10	3.2	2900	Dir	G 1½"- DN32 PN6	6 mm
③	AP bluePRO 200/2/G40H A1CT5	400	3	-	1.50	4.3	2900	Dir	G 1½"- DN32 PN6	6 mm

# AP bluePRO

## Dimensions

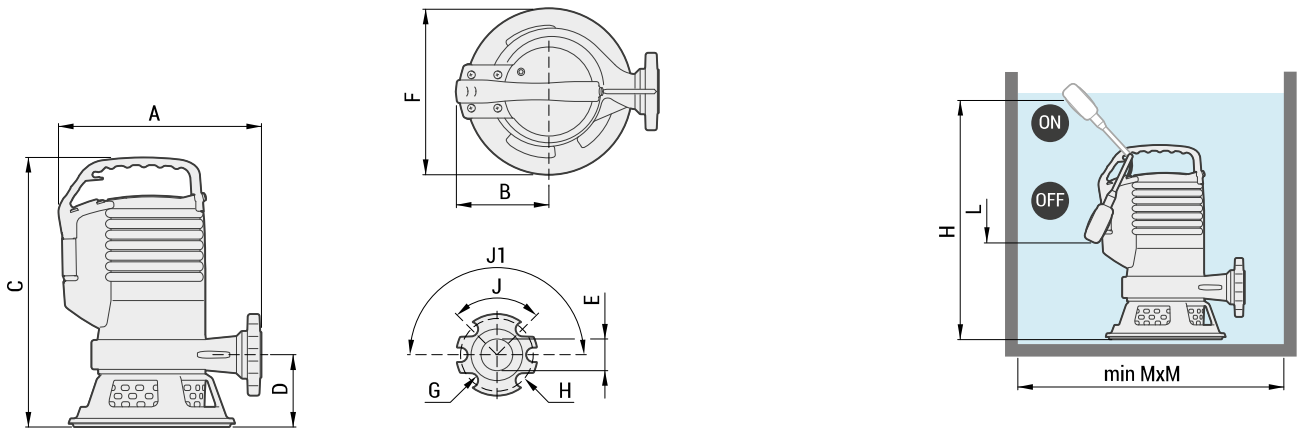

Overall dimensions (mm)

	Overall dimensions (mm)													kg				Pieces per pallet 1000x1200 mm
	A	B	C	D	E	F	G	H	J	J1	H	L	M		X	Y	Z	
AP bluePRO 100/2/G40H A1CM[T]5	270	130	365	95	GAS 1½"	220	14	90	90°	180°	450	240	450	19	250	300	400	48 (16x3) 32 (16x2)
AP bluePRO 150/2/G40H A1CM[T]5	285	125	410	100	GAS 1½"	230	14	90	90°	180°	495	285	450	24	250	300	440	32 (16x2)
AP bluePRO 200/2/G40H A1CM[T]5	285	125	410	100	GAS 1½"	230	14	90	90°	180°	495	285	450	26	250	300	440	32 (16x2)

M - Minimum dimensions. Suggested dimensions 500mm x 500mm

## Versions

### Single-phase models

- TC Thermal protection, capacitor
- TCG Thermal protection, capacitor, float switch

### Three-phase models

- NAE No electric accessory
- TRG Thermal protection, relay for motor protection, float switch

## Packaging



The rugged cardboard box packaging fulfils two functions: it protects the product in transit, thanks to the thickness of the board used and expanded polyurethane padding, and also provides key information about the pump's use and performance data, printed clearly and legibly in colour. Pumps are supplied complete with all the documentation required by European standards and a copy of the duty dataplate on a silvered decal that can be affixed to the manual to ensure the availability of all the most useful data (serial number, power rating, etc.) at all times.

## Installations

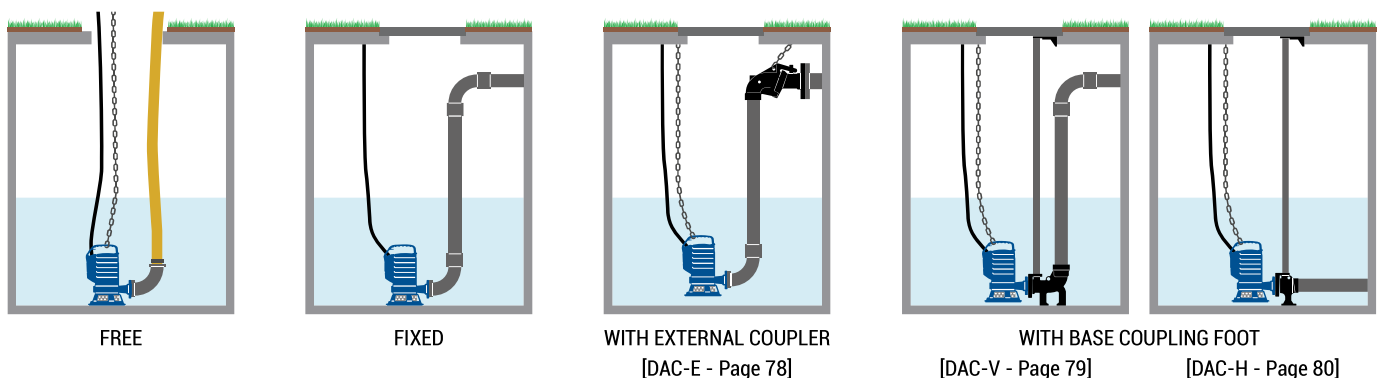

FREE

FIXED

WITH EXTERNAL COUPLER  
[DAC-E - Page 78]

WITH BASE COUPLING FOOT  
[DAC-V - Page 79]

WITH BASE COUPLING FOOT  
[DAC-H - Page 80]